

HAIFA TRAIN STATION PROJECT

SITE ANALYSIS

The land is located in the Palestinian city of Haifa and in a very important location, which is the place of the main old station, and in a location very close to the old city,

There are old railway-lines linking very important directions between the Old City, a line that connects to the displaced Palestinian villages, a commercial line with the port, in addition to the lines with the most important cities Palestinian Acre, Jerusalem and Nablus

The Old Station

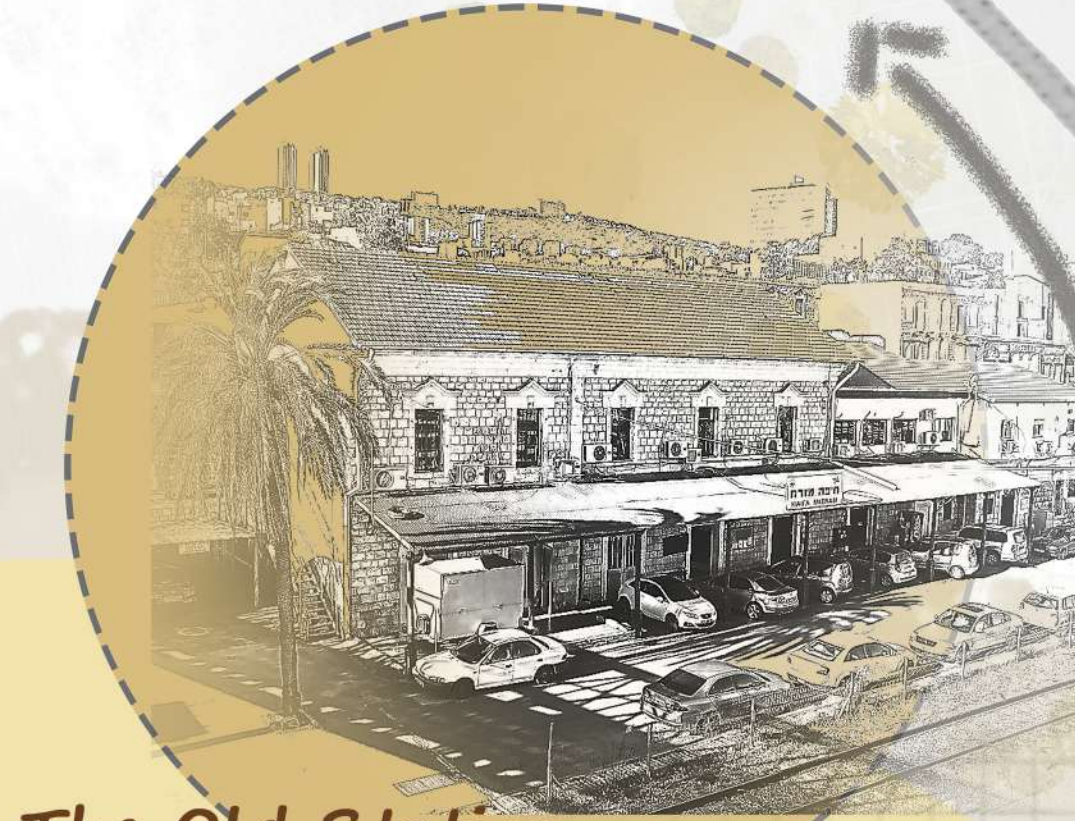

- TRANSPORTATION
- port
 - Bus station
 - Railroad Tracks
 - Railway

THE PROJECT CONCEPT

A DEPARTURE FROM THE PREVAILING ARCHITECTURAL STYLE TO A COMPLETELY DIFFERENT ARCHITECTURAL STYLE, IN SUPPORT OF THE IDEA OF STRENGTHENING THE OLD PART AND SHOWING THE NEW CHANGES

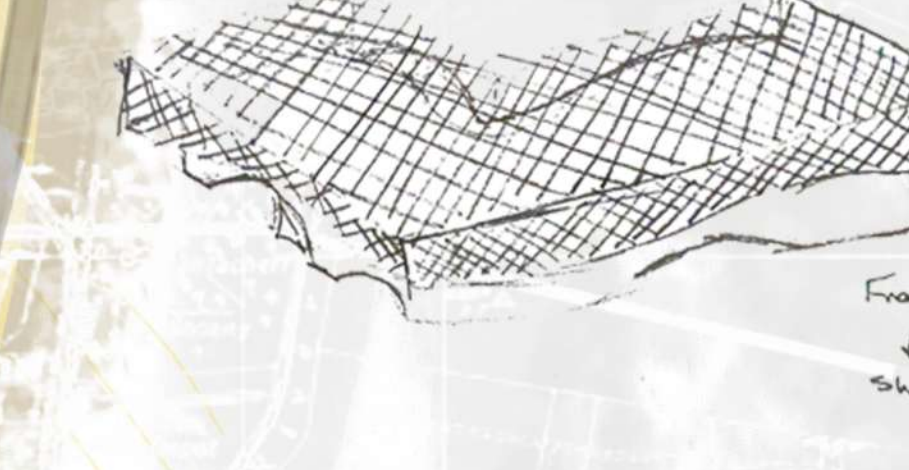
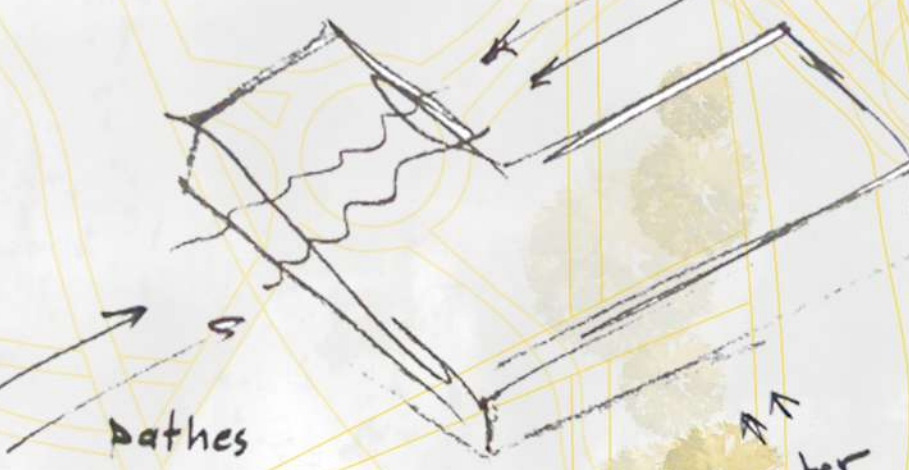

The use of an external structure as an external covering is inspired by the ancient architectural style of Mashrabiya and geometric decorations in a beach

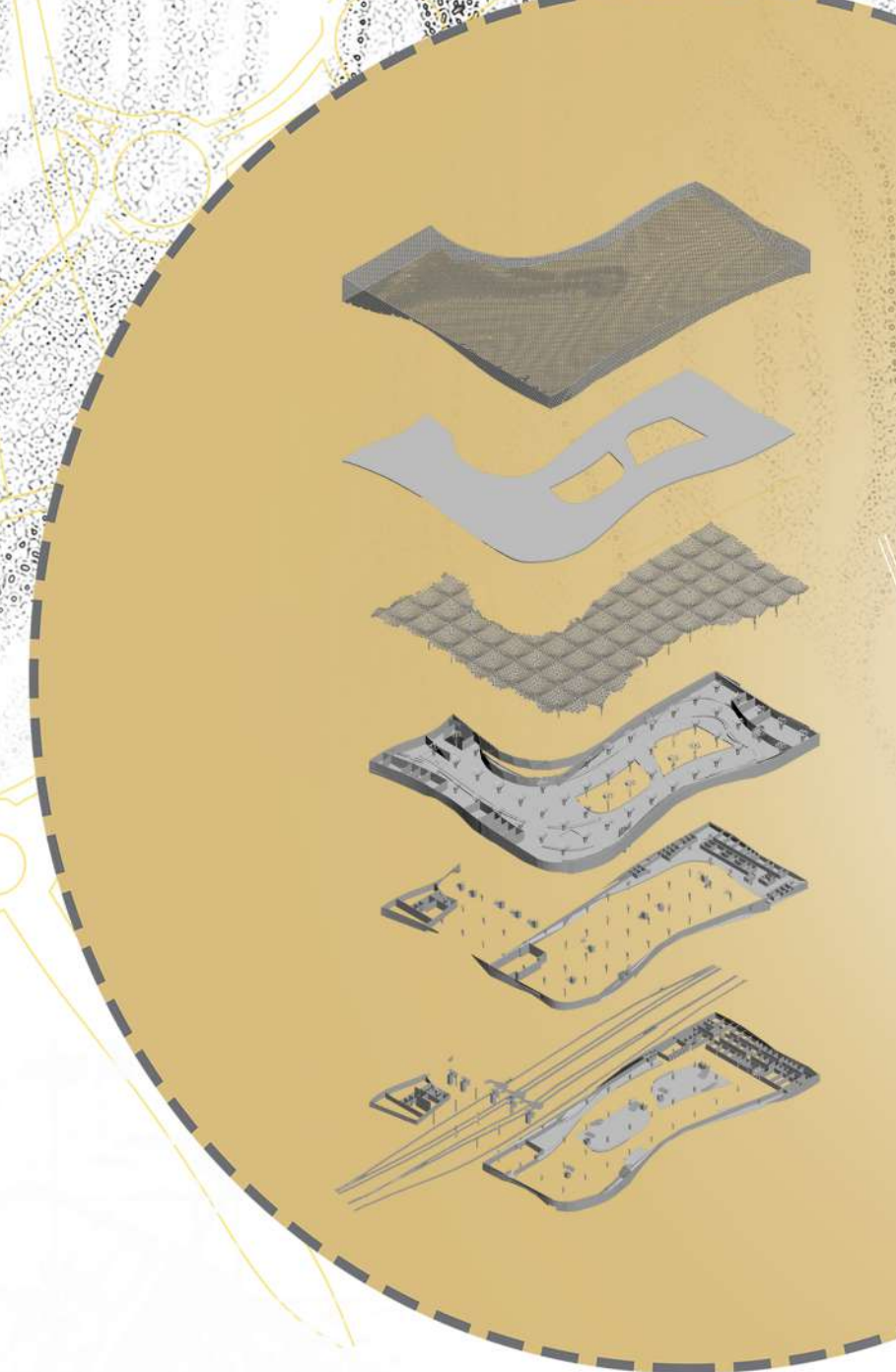

The concept was to take the old Hijaz railway lines and express them, including their overlap with the difficult terrain of Palestine, which in turn formed curved lines that crossed what the railways in Palestine passed through over time and express them in the main Haifa station

2D DRAWING

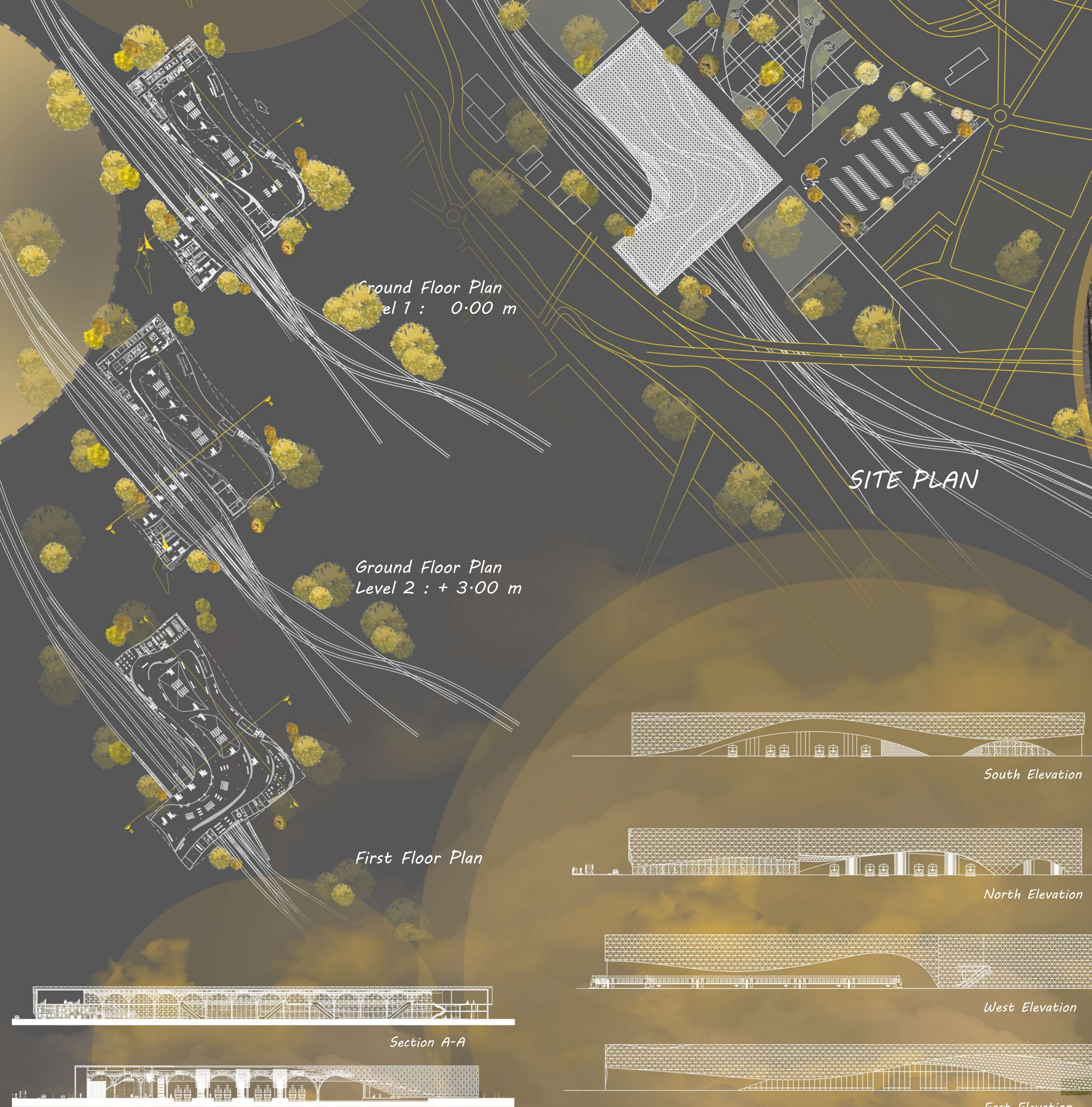

RENDER VIEWS

